

ATLANTIC YARDS CONSTRUCTION UPDATE
Weeks of October 25, 2010 through November 7, 2010

In an effort to keep the Atlantic Yards Community aware of upcoming construction activities, ESD and Forest City Ratner provide the following outline of anticipated upcoming construction activities.

Please note: the scope and nature of activities are subject to change based upon field conditions. In addition, during the utility work water shut offs may be required; these shut downs are done under the oversight of DEP and property owners will be given advance notice. All work has been approved by appropriate City and State agencies where required.

If you have any questions please feel free to contact our project Ombudsperson at:
212-803-3233 or AtlanticYards@empire.state.ny.us

Weeks covering October 25, 2010 through November 7, 2010

Long Island Rail Road/Vanderbilt Yard Work

- Contractor has completed the work required for the installation and load testing of piles. The contractor will now commence the work necessary to install 7'x7' spread footing and perform the required load tests. This work is taking place approximately 100 feet east of the Carlton Ave Bridge in block 1121.
- During this reporting period work related to the demolition of the Carlton Ave Bridge and the associated piers located in the north side of the existing LIRR yard located within blocks 1120 & 1121 may commence. Initial work will consist of the abatement of the lead paint which will be limited to approximately one foot on either side of cut lines for the removal of the steel. A chemical peel process will be used; if this is unsuccessful the contractor will use a process involving needle scalers to remove the paint in these areas. In either case, the removed paint will be captured and disposed of appropriately. The contractor has applied for all the required permits and submitted to the LIRR for approval. Work will commence upon receipt of such approvals and permits which are anticipated to be in place during this reporting period.
- Maintenance and Protection of Traffic (MPT) will be installed along Atlantic Avenue to facilitate the demolition of the north approach slab and abutment that previously served the Carlton Avenue Bridge. It will be installed in the following sequence (plans showing the MPT are attached):
 - The median work along Atlantic Avenue would be conducted first with MPT setup per MPT-4. All the work would be done during the overnight period over 3-5 five days (or about less than a week).

- After the median work is completed, shut down MPT-4 and set up for the Carlton Avenue (and the south side of Atlantic Ave) work as shown on MPT-2 and MPT-3, which will remain in place until bridge is completed (approximately two years or until arena opens).
 - Once the Carlton Avenue Bridge is finished, MPT-4 is set up again so the contractor has access to create the left turn lane on the westbound approach on Atlantic Avenue (which can be completed in 1-2 overnights).
- Contractors to commence the construction of the AO1-2 concrete vault and transformer pad along with the associated electrical ductbanks. This work will take place in the north side of Block 1120 just east of lot 19. This work activity has an estimated duration of 4 weeks.
 - Soil borings on Block 1120 and 1121 are to begin during this reporting period. These borings are being done to conduct percolation testing of soil for future drainage basin design.

Environmental Remediation

- Soil that has been classified as clean, contaminated or hazardous will be removed from the site as part of the excavation activities and brought to appropriate disposal locations.
- Where excavation and soil moving activities occur in areas of known VOCs (BL 1119, lot 1 & 64, BL 1118, lot 1 and BL 1127, lot 1) Volatile Organic Compounds (VOC) monitoring will be performed as required in the Community Air Monitoring Plan (“CAMP”) and VOC Best Monitoring Practices documents.
- CAMP monitoring is continuing on all areas of soil disturbance per the project plan, including excavation, grading and demolition.
- Additional soil characterization soil borings to facilitate future soil disposal and disposal facility selection may occur within Block 1127. This work is dependent on site availability and access.
- Removal of a previously cleaned and decommissioned 1,080 gallon fuel oil UST located on Block 1127 Lot 50 is scheduled to take place during this reporting period pending site access availability and coordination.
- In-situ chemical oxidation injections will continue during this reporting period at Block 1118 Lot 1 and Block 1119 Lot 1. These injections will be completed as a remedial action under jurisdiction of New York State Department of Environmental Conservation through temporary well points in order to facilitate coordination with construction activities.

Infrastructure

- A new water trunk main will be installed along Atlantic between Flatbush and 6th Avenue and associated distribution mains will be installed in the Flatbush/Atlantic Avenue intersection, and approximately 200 feet south in Flatbush toward Pacific Street. Work related to an exploratory trench across Flatbush near Atlantic will continue during this period. The work in Flatbush will be performed at night and traffic will be restored every morning according to DOT stipulations. Most of the work in Atlantic Avenue will be performed during the day behind the barriers that were installed earlier this year for the arena construction. In a small area west of the intersection of 6th Avenue one lane of eastbound traffic will be occupied by test pit work that will be performed at night under standard DOT stipulations. Traffic will be restored before morning rush hour. At other select test pit locations, for purposes of coordinating with work being done by other project contractors, night work may be performed behind barriers. Traffic will not be affected in these locations.
- During the course of utility installation work, the contractor may encounter unforeseen contaminants, underground storage tanks or other structures. In the event that this happens and where appropriate, notification will be given to the DEC, VOC monitoring will be continuously performed, and remediation steps will be implemented.

Demolition

- Demolition is complete at 24 6th Avenue and debris removal will be complete during this two week period. Demolition will continue at 636 Pacific Street and is expected to be complete in November. During this work period, after debris removal at 24 6th Avenue is complete, the demolition work zone fences will be moved in to allow the arena work to continue in that area.
- Demolition at 636 Pacific will be demolished by hand until they are down to a level at which the surrounding buffer zone allows safe mechanical demolition. This is determined by the demolition engineer and approved by NYC BEST Squad. Work will be performed on Saturdays as well as during the regular work week. Work is being performed pursuant to permits granting after hours and weekend work.
- Asbestos abatement is complete at 810 and 812 Pacific and is in progress at 802 Pacific and 540 Vanderbilt and is expected to be completed within this reporting period.

Arena

- The removal of the rakers, tie backs, walers and thrust blocks associated with the Atlantic Avenue SOE adjacent to the LIRR tunnel will begin during this reporting period. Excavation for the arena foundation in the area of Atlantic Avenue and within the BL1119 portion (at the closed 5th Avenue and Pacific Street) of the Arena footprint continues.

- Installation of SOE along the western portion of the arena building, continuing down Flatbush to Dean continues during this period. Within this same area, excavation will continue within the footprint of the arena (block 1127). Drilling will continue east of the Dean and Flatbush intersection at Dean Ave perimeter wall within this reporting period. Drilling will start on the 6th Avenue elevation during this period.
- SOE installation and related excavation of the southeast corner of the arena, paralleling Dean Avenue, continues. VOC monitoring as required by the CAMP, as well as use of enhanced personal protective equipment (PPE) in some instances, will continue during SOE installation and excavation work on Block 1127 Lot 1.
- Installation of concrete footings along the eastern end of BL1119 and Atlantic Avenue will continue during this reporting period.
- Installation of perimeter concrete foundation walls along the Atlantic Avenue elevation will have been completed. The application of waterproofing to the foundation walls from the 6th avenue starting point north and then west down Atlantic Avenue will continue during this reporting period.
- The excavation for the west storm retention tank below the closed 5th Ave. area continues this period, as well as the forming of the tanks base & walls, and the concrete placement of the pit bottom slab and the additional sections of the pit walls.
- Layout/installation related to the underground plumbing will continue within the northeast quadrant (near Atlantic Avenue & 6th avenue portion of the site) and will proceed west down Atlantic Avenue during this reporting period.
- The removal of the retention wall along the north side of the former Pacific Street and the creation of a new access ramp into the site from Pacific Street will continue this period. The retention wall removal procedure has been submitted and reviewed/approved by DOB.
- Underground electrical duct bank installation will continue during this reporting period. This work is taking place within Lot 1119 where the concrete foundations and footings are being poured. Work, formwork and rebar placement, related to the installation of the perimeter wall at the east end (6th Avenue) will continue during this reporting period.
- Installation of the remaining portions of the 16' fence along Dean Street and Flatbush Avenue will resume upon receipt of necessary approvals from DOB.
- The preparation of the site to accommodate the mobilization of the steel erector will start this period. During the course of this work, the contractor may encounter unforeseen contaminants, underground storage tanks or other structures. In the event that this happens and where appropriate, notification will be given to the DEC, VOC monitoring will be continuously performed while excavating these materials and remediation steps will be implemented.

- Atlantic Yards is participating in the City’s Urban Canvas program which is managed by the City’s Department of Buildings; as such a decorative covering will be installed on a portion of the construction fence facing Atlantic Avenue (approximately 200 feet in length); it is one of four sanction designs selected by the City. To find out more information about the program go to the DOB web site (www.nyc.gov/urbancanvas) and search for Urban Canvas.

NYC Transit Improvements

- Drilling of Test Piles within the project footprint (block 1118) continues to take place, followed by load-testing of mini-piles to be used for the foundations of the new Transit entry area. When the design capacity of the test pile has been verified, all structural piles will be drilled. Piles for the support of excavation along Atlantic Avenue have been substantially completed and excavation is now underway. Vibration and Tilt sensor have been installed and are being monitored per NYCT requirements.
- Work related to the excavation of test holes at various points within the project footprint will continue during this period as well.
- Classification of soil will be completed for proper disposal, as selective excavation continues. The soil testing work has been completed, except for one area for which access is not yet available. All soil has tested as “non-hazardous”.
- Demolition of the TA structures has commenced. IRT and BMT Tunnel inspections have taken place and repair work will be implemented during scheduled NYCT track outages during evenings and weekends.
- Permits have been secured for the portions of the street immediately adjacent to the “Tip” of the project area (at the corner of Flatbush and Atlantic). These areas have been opened up and will be re-closed with temporary decking to allow construction work to proceed below street grade. This work will be performed at night and traffic will be restored every morning according to DOT stipulations. The temporary decking placement work will continue until the beginning of December.

Community Liaison Office (CLO)

Persons seeking access should do so from Dean Street. Both the CLO phone line (866-923-5315) email (communityliaison@atlanticyards.com) are operational and community residents are encouraged to use both when making inquiries about the project.

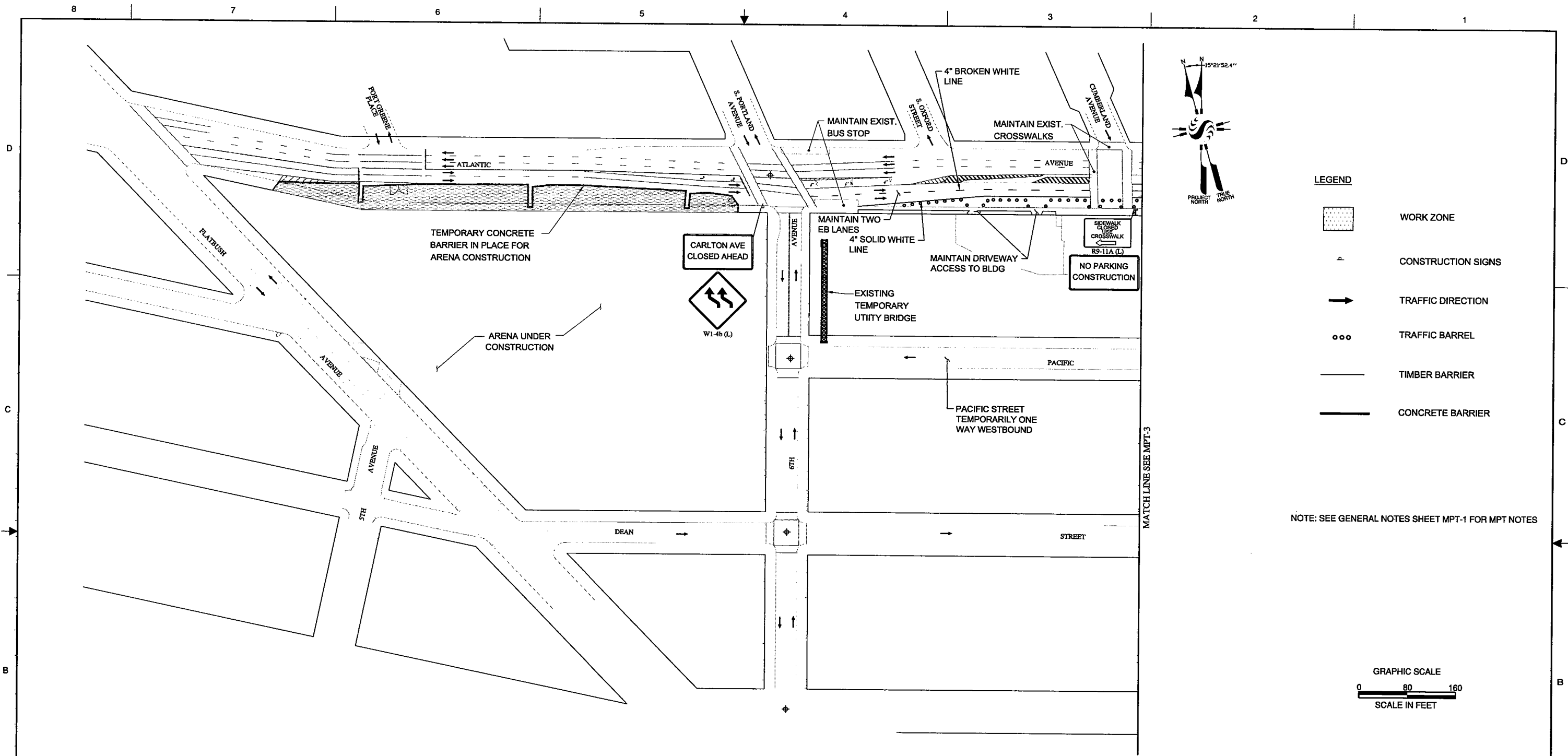

- LEGEND**
- WORK ZONE
 - CONSTRUCTION SIGNS
 - TRAFFIC DIRECTION
 - TRAFFIC BARREL
 - TIMBER BARRIER
 - CONCRETE BARRIER

NOTE: SEE GENERAL NOTES SHEET MPT-1 FOR MPT NOTES

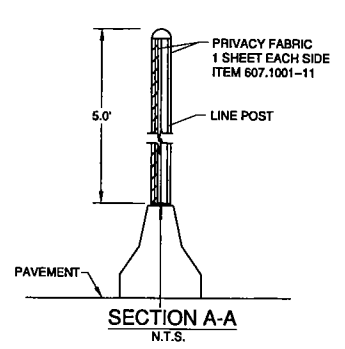
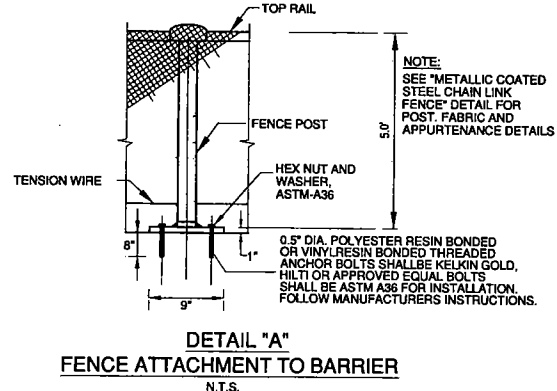
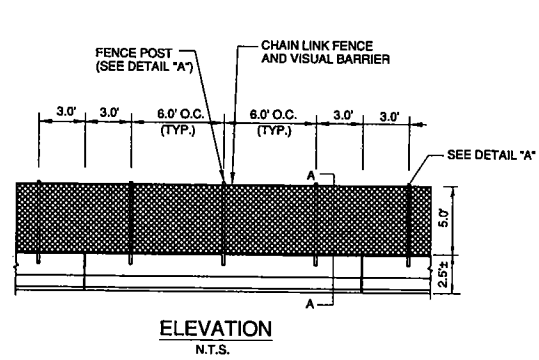
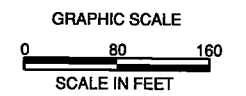

CHAIN LINK FENCE ON TOP OF TEMPORARY CONCRETE BARRIER DETAILS

REV. 2 06/30/2010
90% SUBMISSION

RECONSTRUCTION OF
CARLTON AVENUE BRIDGE OVER LIRR
BOROUGH OF BROOKLYN B.I.N. 2-24329-0

MAINTENANCE AND PROTECTION OF
TRAFFIC PLAN-1

DWG. NO. MPT-2	SCALE AS SHOWN	DATE 06/30/10	SHEET 14
-------------------	-------------------	------------------	-------------

50 WEST 23rd STREET, NEW YORK, NY 10010-5205
TEL 212 366 5600 FAX 212 366 5629

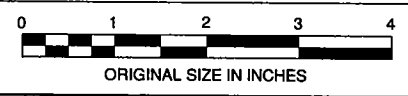

PREPARED BY
IN CHARGE S. LERNER DRAFTER G. SPRICH*
DESIGNER G. SPRICH CHECKER N. CATALANO

N. Y. C. D. O. T. MICROFILM IDENTIFICATION NUMBER
B I N **2-24329-0** R O L L **L35** F R A M E **014**

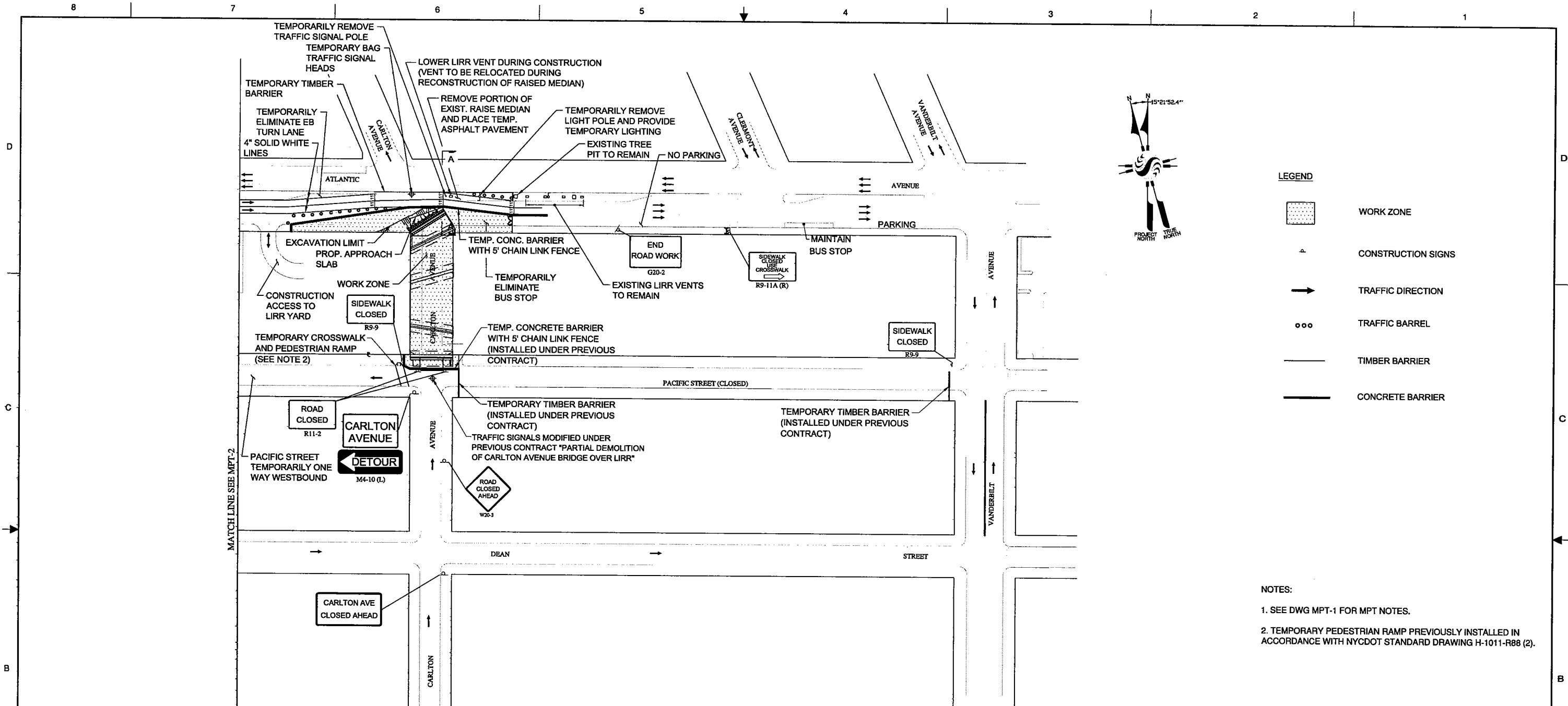

- LEGEND**
- WORK ZONE
 - CONSTRUCTION SIGNS
 - TRAFFIC DIRECTION
 - TRAFFIC BARREL
 - TIMBER BARRIER
 - CONCRETE BARRIER

- NOTES:**
- SEE DWG MPT-1 FOR MPT NOTES.
 - TEMPORARY PEDESTRIAN RAMP PREVIOUSLY INSTALLED IN ACCORDANCE WITH NYCDOT STANDARD DRAWING H-1011-R88 (2).

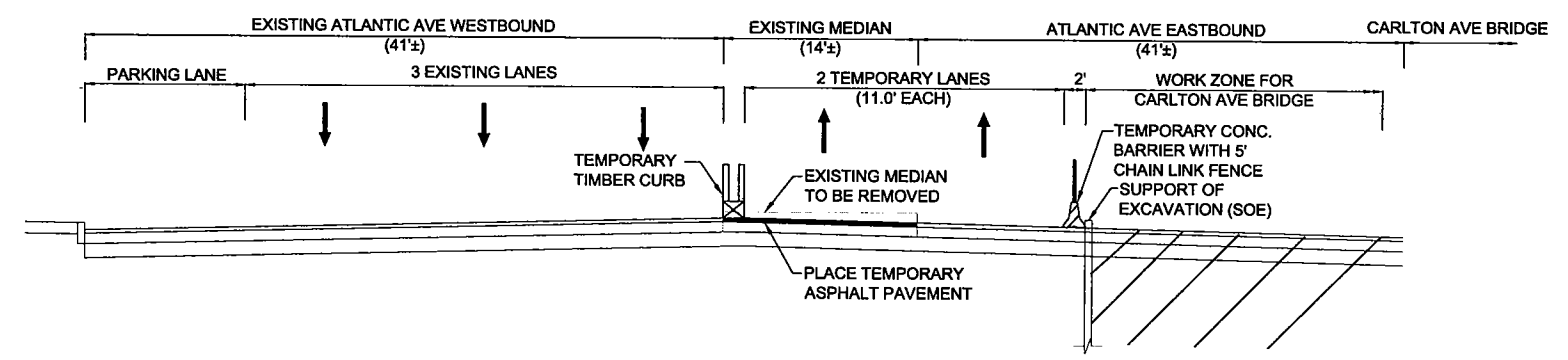
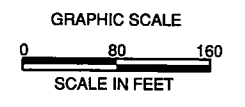

SECTION A-A
NOT TO SCALE

REV. 2 06/30/2010
90% SUBMISSION

**RECONSTRUCTION OF
CARLTON AVENUE BRIDGE OVER LIRR**
BOROUGH OF BROOKLYN B.I.N. 2-24329-0

**MAINTENANCE AND PROTECTION OF
TRAFFIC PLAN-2**

DWG. NO. MPT-3	SCALE AS SHOWN	DATE 06/30/10	SHEET 15
-------------------	-------------------	------------------	-------------

50 WEST 23rd STREET, NEW YORK, NY 10010-5205
TEL 212 366 5600 FAX 212 366 5629



PREPARED BY
IN CHARGE S. LERNER DRAFTER G. SPRICH
DESIGNER G. SPRICH CHECKER N. CATALANO

N. Y. C. D. O. T. MICROFILM IDENTIFICATION NUMBER
B I N **2-24329-0** R O L L **L35** F R A M E **015**

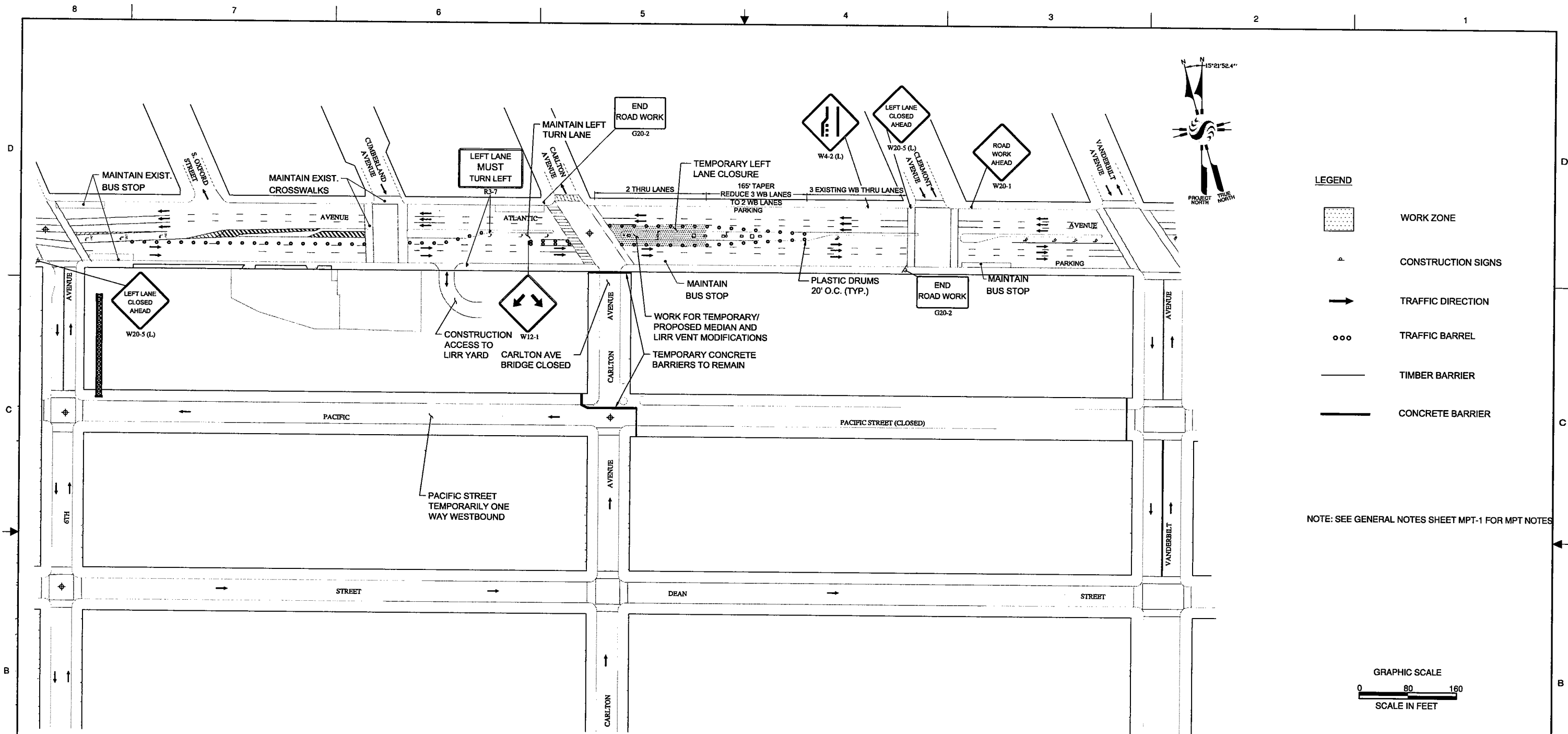

- LEGEND**
- WORK ZONE
 - CONSTRUCTION SIGNS
 - TRAFFIC DIRECTION
 - TRAFFIC BARREL
 - TIMBER BARRIER
 - CONCRETE BARRIER

NOTE: SEE GENERAL NOTES SHEET MPT-1 FOR MPT NOTES

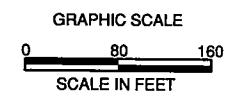

REV. 2 06/30/2010
 90% SUBMISSION

RECONSTRUCTION OF
 CARLTON AVENUE BRIDGE OVER LIRR
 BOROUGH OF BROOKLYN B.I.N. 2-24329-0

MAINTENANCE AND PROTECTION OF TRAFFIC
 FOR ATLANTIC AVENUE MEDIAN MODIFICATION

50 WEST 23rd STREET, NEW YORK, NY 10010-5205
 TEL 212 366 5600 FAX 212 366 5629

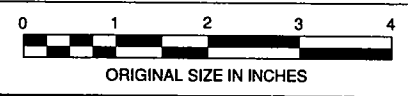

PREPARED BY
 IN CHARGE S. LERNER DRAFTER A. CAMARA
 DESIGNER F. KHAN CHECKER N. CATALANO

N. Y. C. D. O. T. MICROFILM IDENTIFICATION NUMBER
 B I N **2-24329-0** R O L L **L35** F R A M E **016**

DWG. NO. MPT-4	SCALE AS SHOWN	DATE 06/30/10	SHEET 16
-------------------	-------------------	------------------	-------------

Atlantic Yards Demolition Status

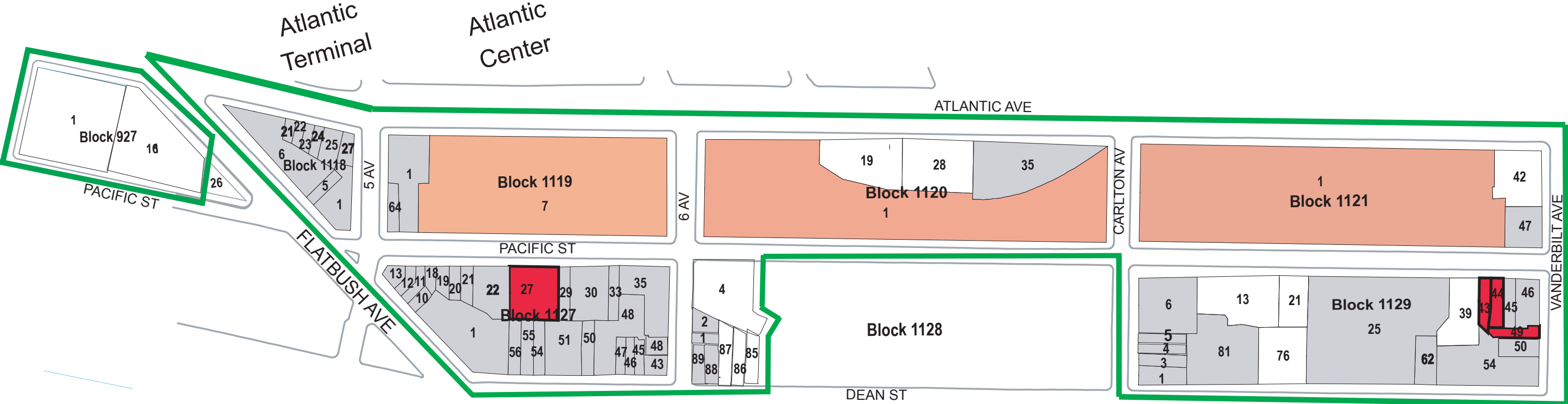



- vacant lot
- Abatement or Demolition Underway
- LIRR Yard

Trunk & Water Main

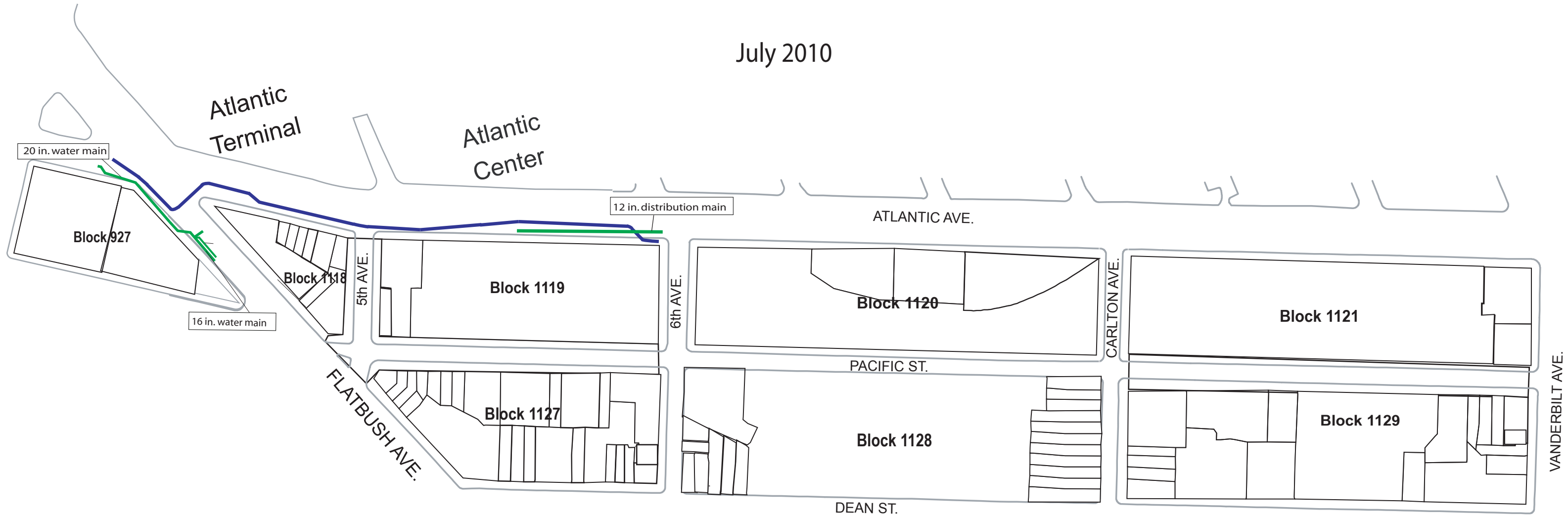
July 2010



-  36"/48" trunk water main
-  12", 16", & 20" water main & 12" Distribution Main